

# DRAWN SOLID WIRE

## DESCRIPTION:

Our Drawn Solid Wire is drawn from ASTM B49 copper rod. Drawn Wire is produced with a smooth, clean, bright surface finish that is free of oxidation. Our Drawn Wire is packaged in either cardboard boxes or steel reels.

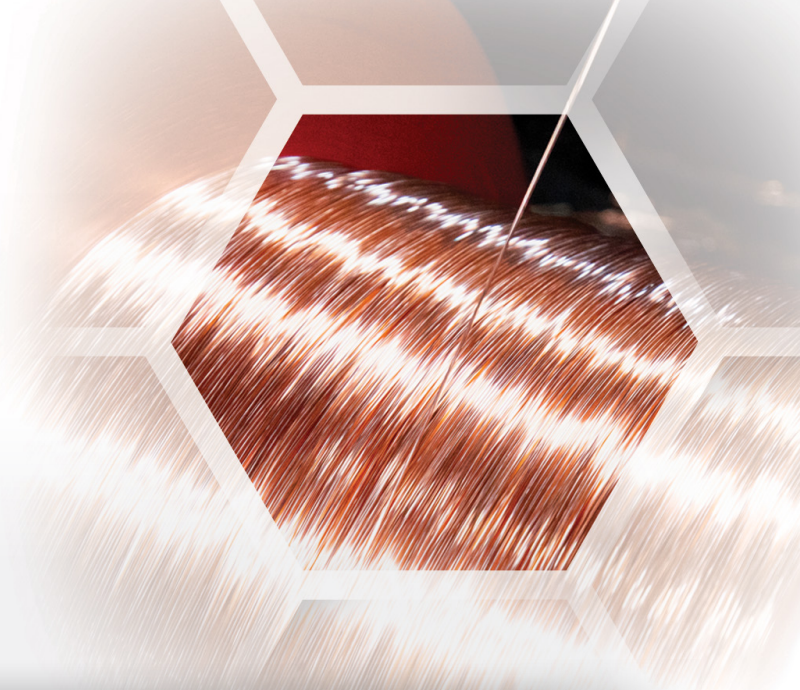

## REEL DIMENSIONS

	DIN 800		DIN 710		DIN 630	
	(in)	(mm)	(in)	(mm)	(in)	(mm)
Flange	31.5	800	27.95	710	24.8	630
Width (OAW)	22.44	570	16.73	425	18.75	476
Traverse Width	19.69	500	13.97	355	15.75	400
Drum	17.72	450	13.97	355	12	305
Arbor	5	127	5	127	5	127

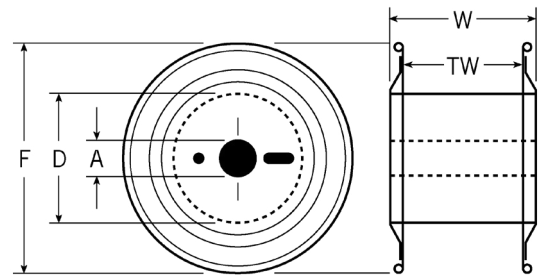

## STANDARD SIZES

AWG	(in)	(mm)
6	0.1620	4.115
8	0.1235	3.263
10	0.1019	2.588
12	0.0808	2.052
14	0.0641	1.627
16	0.0508	1.290



## CARDBOARD BOX PACKING DIMENSIONS

AWG	(in)
Height	37.5"
Diameter	44"
Core Diameter	~21"
Skid Height	~5"

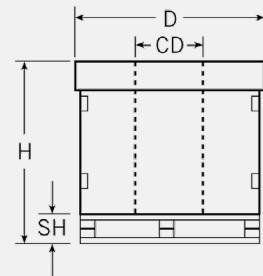

### DISCOVER HOW WE CAN MAKE COPPER WORK FOR YOU.

Contact our team of experts to discuss your copper wire needs and how we can help you gain efficiencies and meet your goals.

### THIS IS WHERE COPPER WORKS!

1640 South Ryan Road | New Haven, IN 46774

Ver. 6/24

**SALES: 260.748.6550**

**OFFICE: 260.748.6565**

**FAX: 260.748.6567**

**TF: 855.523.2742**

**COPPERWORKS.COM**